

Apartment

FLAT 2, 49 REPORTON ROAD, FULHAM, LONDON, SW6 7JP

Per Month

£1,650 Per

FEATURES



TUCKERMAN
ESTATE AGENTS
PROPERTY PROFESSIONALS

1 Bedroom Apartment located in London

A beautifully presented one-bedroom flat with access to a private south-facing terrace, located on a quiet residential street in Fulham.

OPEN HOUSE - Wednesday 10th May - Call to Confirm Attendance

Call us on
020 7222 5510

info@tuckermanresidential.co.uk
www.tuckermanresidential.co.uk

Council Tax Band
D

Raised Ground Floor

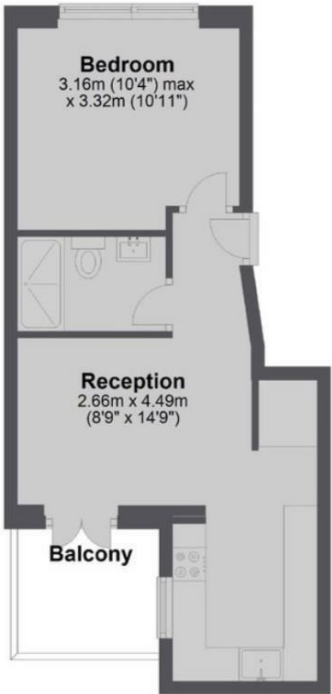

Total area: approx. 32.3 sq. metres (347.5 sq. feet)

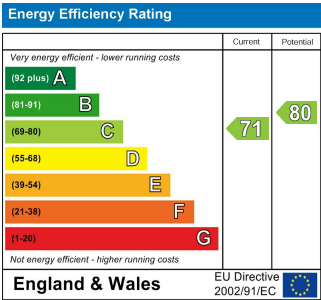

Agents Note: Whilst every care has been taken to prepare these particulars, they are for guidance purposes only. All measurements are approximate and are for general guidance purposes only and whilst every care has been taken to ensure their accuracy, they should not be relied upon and potential buyers are advised to recheck the measurements.